

Uniformance Desktop  
**Retrieve PHD Data Using  
PPT Companion**

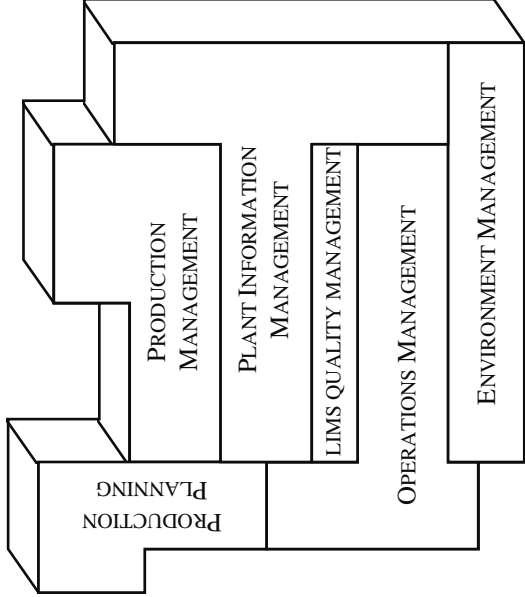

# Lesson Objective

## Objective

Using the PowerPoint Companion and the Honeywell Graphics Library, create graphic displays that retrieve Uniformance data into a PowerPoint presentation.

## Topics

- Purpose and Capabilities of PPT Companion
- Installation of PPT Companion
- VisualPHD Toolbar
- Demonstration of PPT Companion
- Graphics Library
- Hands-on Exercise

The PowerPoint Companion is available on R130 and later.

## References

- *PowerPoint Companion online help*
- *Uniformance PowerPoint Add-In User Guide, PIM-260*

## Purpose and Capabilities of PPT Companion

---

- The Uniformance PowerPoint Companion is an Add-in that provides tools for building “point and click” process graphics.
- It was designed specifically for users who are new to graphic display building and do not know VB/VBA.
  - It provides a toolbar for adding VisualPHD ActiveX objects to slides to display live PHD data.
  - Users do not have to write VBA code
  - Wizards aid display creation, prompting users for the minimum information required
  - Clipart from the Honeywell Graphics Library can be included in slides (such as tanks, pumps, and towers)
  - Supports PowerPoint 97 standalone viewer (so the file can be distributed to end users who do not have PowerPoint)
- MS Excel worksheets created with the Uniformance Excel add-in can be embedded in a PowerPoint presentation.
- Office 2000 (R150 and later)
  - The PowerPoint Companion for Office 2000 embeds objects that can be translated to HTML VB script, enabling you to maintain the same functionality under HTML as displayed in the presentation.
  - Without the 2000 companion, only the presentation display and any hyperlinks are ported to the web (none of the VBA code is translated to HTML.).

## Installation of PPT Companion

- Install the PowerPoint 97 Companion from the Honeywell Uniformance software CD. Before you can use the PowerPoint 97 Companion, you must load it as a PowerPoint add-in.

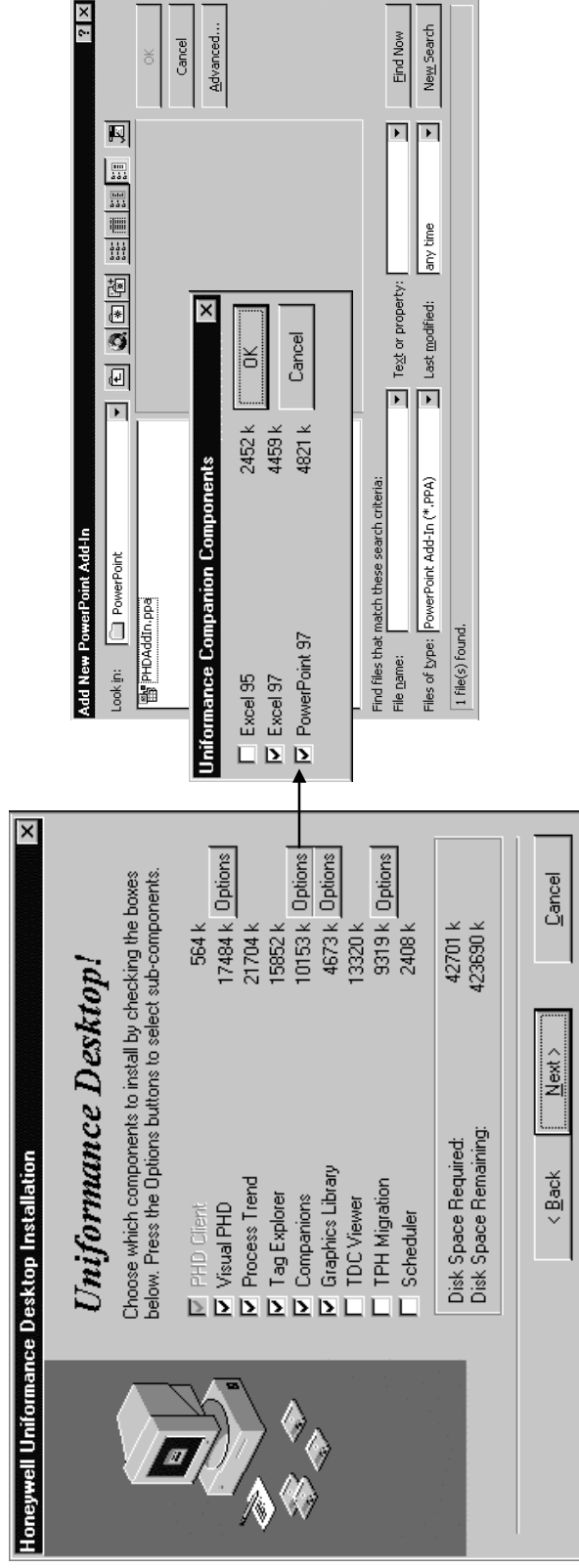

- Install the PowerPoint 2000 Companion separately from the standard Uniformance Desktop.

The file is a COM dll. The install program adds the file to the client's PC and registers it. When the Microsoft Office products load, they check the registry for any COM add-ins and load them automatically.

## VisualPHD Toolbar

- Shown below is the VisualPHD toolbar that is displayed immediately after you load the PowerPoint Companion add-in.

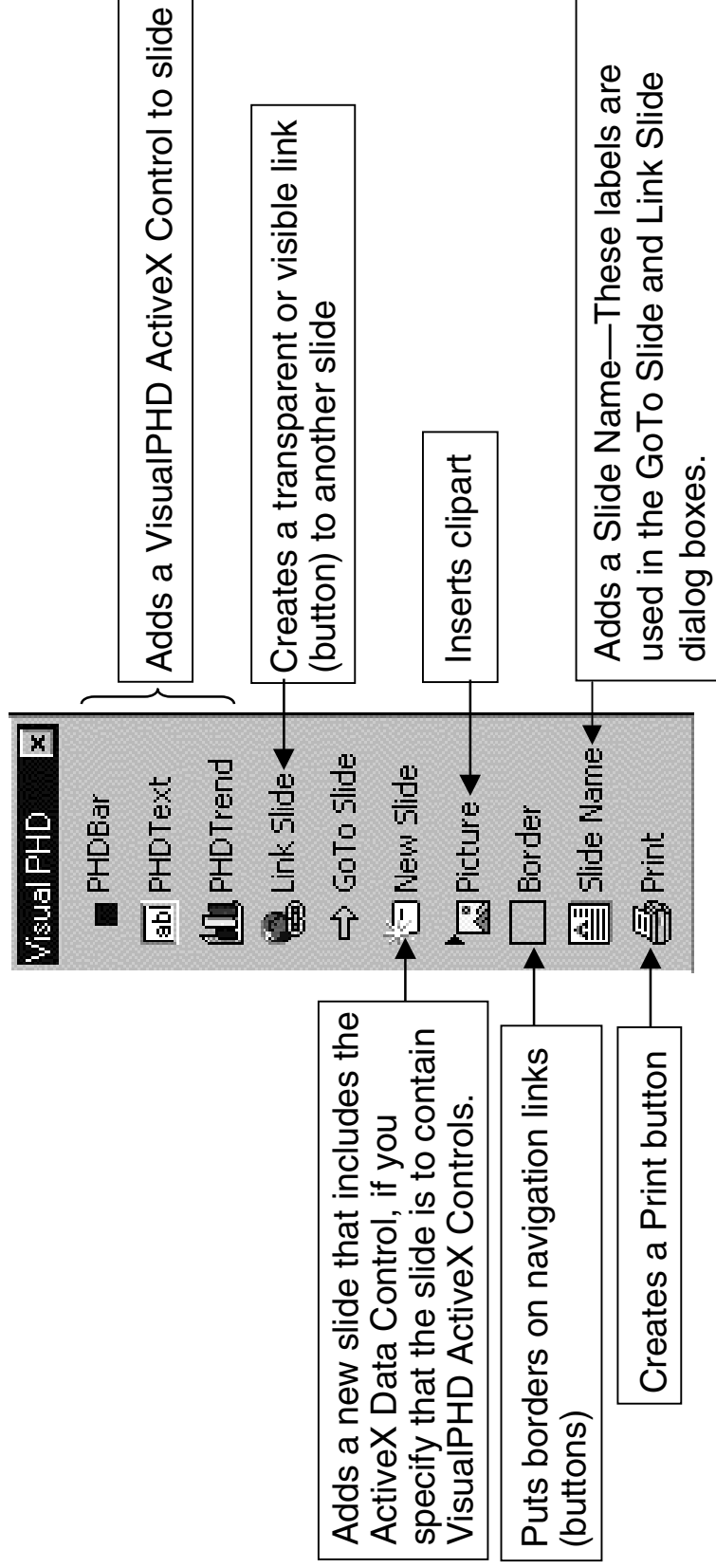

# Demonstration of PPT Companion

Trend

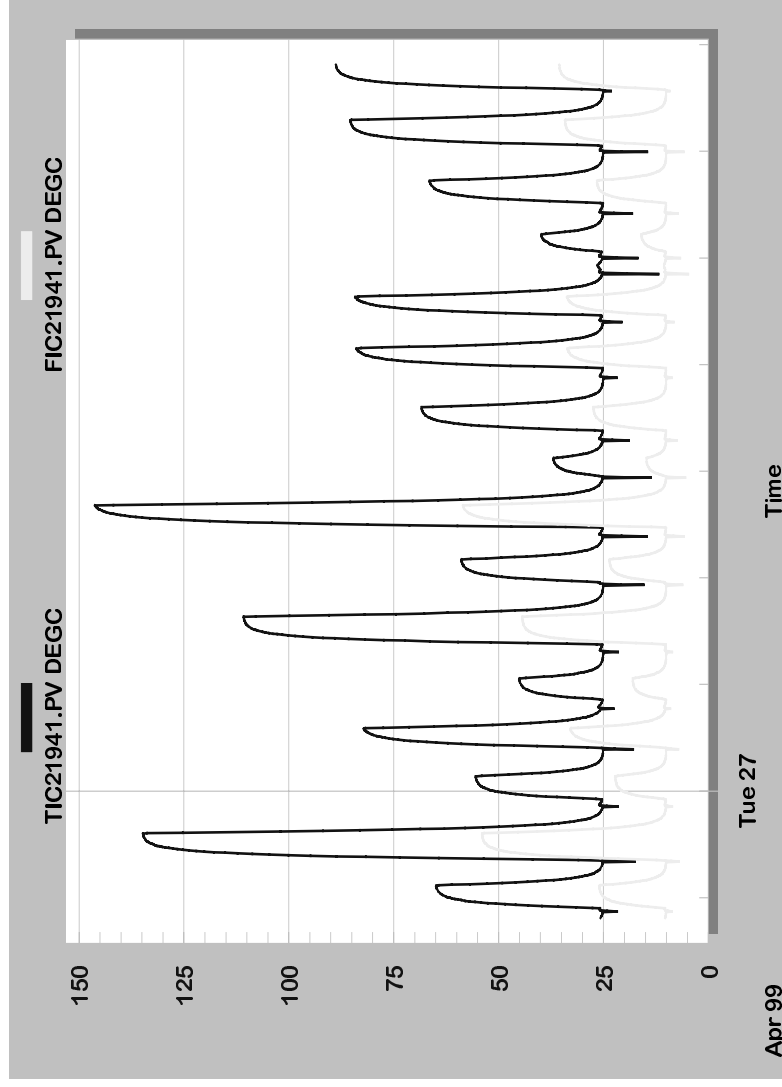

View PHD data through the Bar, Text, or Trend controls

Navigate to other slides with visible or invisible links

Print slide

Graphic

Print



4/26/99 20:25:51

# Demonstration of PPT Companion

Graphic

This is a picture from the Honeywell Graphics Library

You can provide a Slide Name

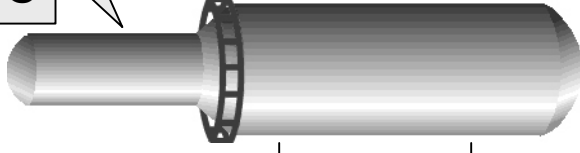

fic21941.pv

DEGC

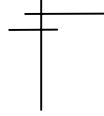

fic21941.pv

KLB/HR

VisualPHD  
text control



4/26/99 20:25:37

Trend

# Graphics Library

If installed, the Graphics Library can be accessed through the VisualPHD toolbar.

The graphics come in standard formats such as Windows Meta-file (.WMF), Jpeg (.JPG), and Enhanced Windows Metafile Format (.EMF), and therefore, can be used in standard drawing packages such as PowerPoint, CorelDraw, Paint, and Word.

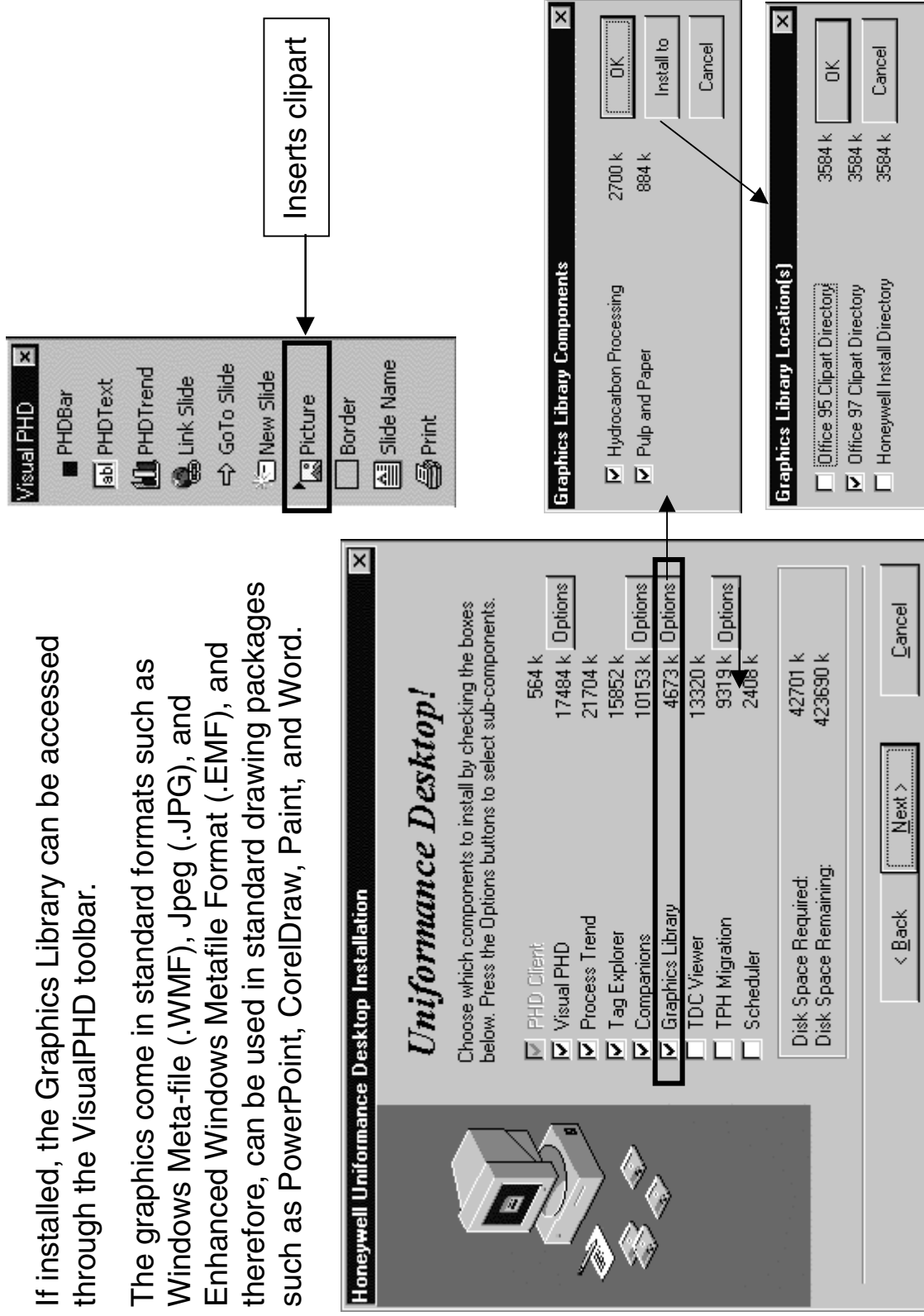



# Graphics Library, *continued*

## Excerpt from Hydrocarbon Processing Library:

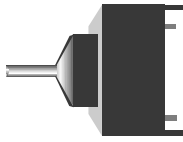

Cabin Furnace

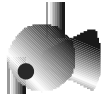

Compressor

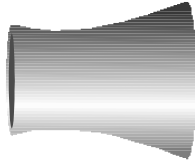

Cooling Tower

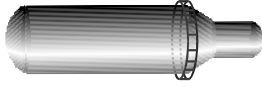

Crude Unit  
Atmospheric  
Tower



Crude Unit  
Vacuum  
Tower

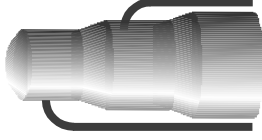

Crude Unit

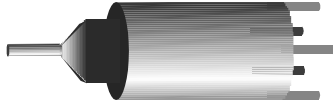

Cylindrical  
Furnace

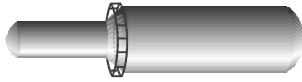

Distillation  
Tower 1

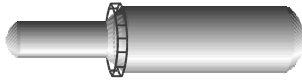

Distillation  
Tower 2

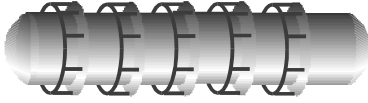

Distillation  
Tower 3

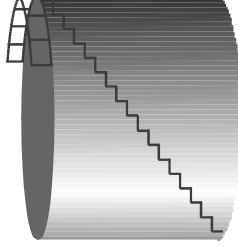

Fixed Roof Tank

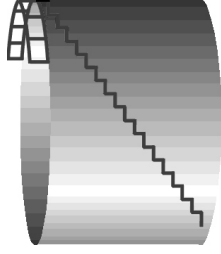

Floating Roof Tank

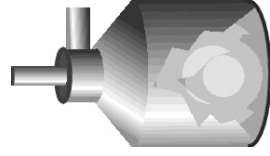

Furnace 1

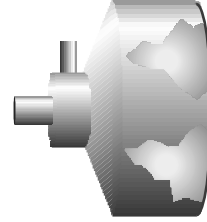

Furnace 2

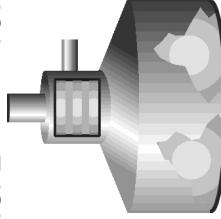

Furnace 3

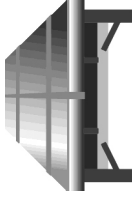

Heat Exchanger



Horizontal Pipe

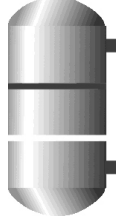

Horizontal Tank

## Graphics Library, *continued*

Excerpt from Pulp and Paper Library:

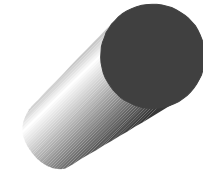

Big Guide Roller

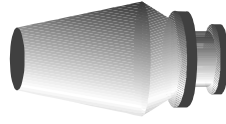

Bin

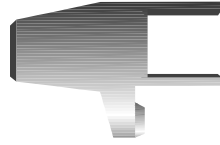

Boiler

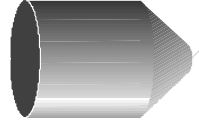

Bulk Feeder

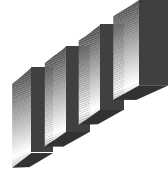

CD Actuators



Cleaner



Coating Frames

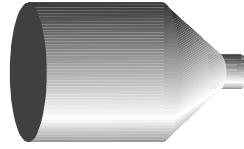

Cone Bottom Tank

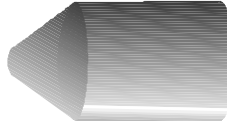

Cone Top Tank



Continuous Digester

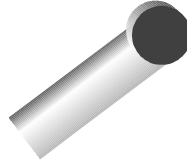

Elbow Pipe

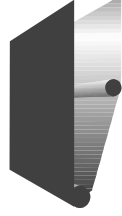

Forming Table

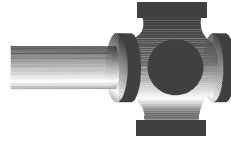

Four-way Connector

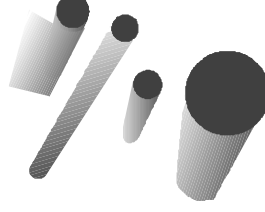

Glide Rollers

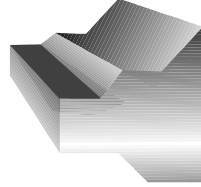

Head Box



Heat Exchanger

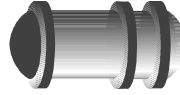

Heater



IR Dryer

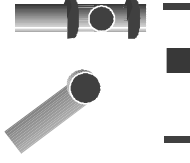

Kiln



Large Pump

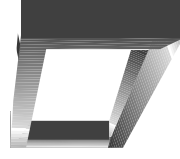

Large QCS

## Software Requirements

---

### Requirements for Developer:

- PowerPoint 97 or 2000
- Oracle SQL\*Net/ODBC32 with the driver for Oracle 7.3 and verify the connection to the PHD Oracle instance
- PowerPoint Companion 97 or 2000 from the Honeywell Uniformance software CD
- VisualPHD from the Honeywell Uniformance software CD
- Although PowerPoint 2000 supports Internet Explorer 4.0 and greater, Internet Explorer 5.0 is recommended.

### Requirements for End User:

- PowerPoint 97 or PowerPoint Viewer
- VisualPHD from the Honeywell Uniformance software CD

# Hands-on Exercise

---

## Instructions

1. Load the Uniformance PowerPoint Companion add-in (PHDaddin).
2. Using the VisualPHD toolbar, create two slides—one containing the VisualPHD trend control, and the other containing VisualPHD text controls.  
Include items from the Honeywell Graphics Library on each slide.
3. Provide links between the two slides.
4. Provide a print button on one of the slides.

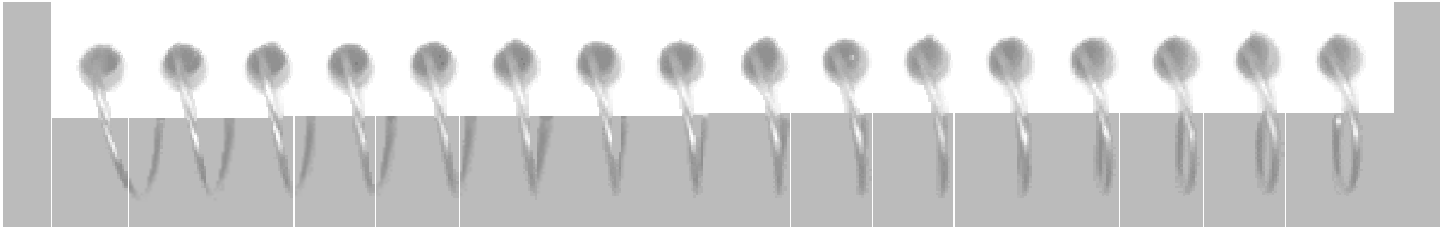

---

# Honeywell

---

*Helping You Manage Your World*  
**[www.iac.honeywell.com](http://www.iac.honeywell.com)**

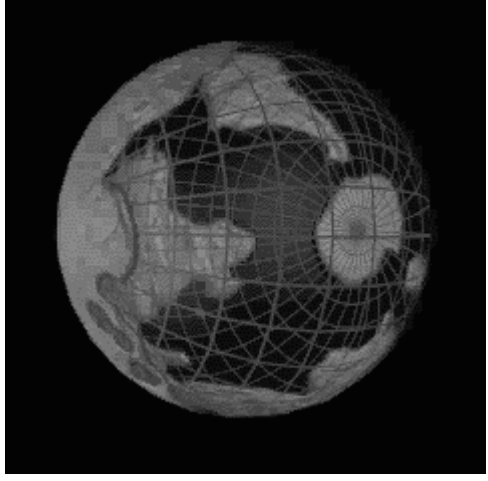

[Return to Graphic](#)